

J-Z Insulated Jumper Wires

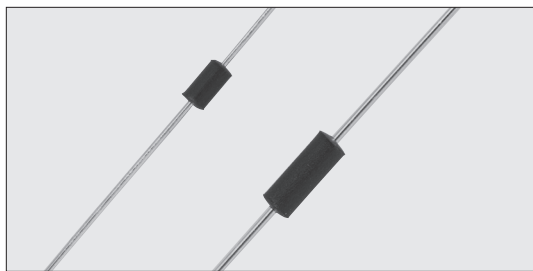

Body color : Black
No marking

Features

- Automatic insertion is applicable.
- Higher than Z series in allowable current.
- Products meet EU-RoHS requirements.

Construction

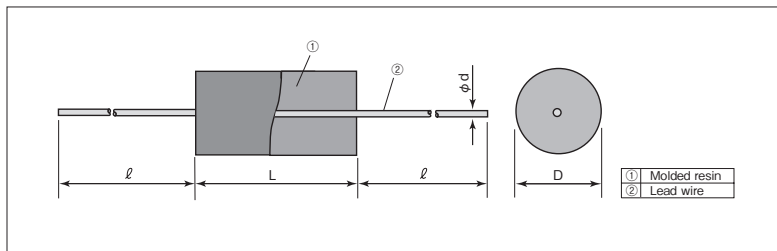

Dimensions

| Type | Dimensions (mm) | | | | Weight (g/1000pcs) |
|-------|------------------------|---------------|-------------|----------------|--------------------|
| | L | D | d (nominal) | $l \pm 3^{*1}$ | |
| J1/6Z | 3.4 ± 0.1 0.2 | 1.7 ± 0.2 | 0.5 | 30 | 110 |
| J1/4Z | 6.5 ± 0.5 | 2.3 ± 0.3 | 0.6 | | 190 |

*1 Lead length changes depending on taping and forming type.

Ratings

| Type | Max. Allowable Current | Rated Ambient Temp. | Operating Temp. Range |
|--------|------------------------|---------------------|-----------------------|
| J1/6ZC | 8A | +70°C | -55°C ~ +125°C |
| J1/4ZC | 10A | | |

Type Designation

Example

| J | 1/6Z | C | T26 | A |
|--------------|--------------|---------------------------|---|--------------------------------|
| Product Code | Style | Terminal Surface Material | Taping | Package |
| | 1/6Z 1/4Z | C : SnCu | T26: 26mm taping T52: 52mm taping Nil: Bulk | A: AMMO R: REEL Nil: BOX |

Contact us when you have control request for environmental hazardous material other than the substance specified by EU-RoHS.

For further information on taping, please refer to APPENDIX C on the back pages.

Taping

| Taping Type Name | Taping & Q'ty (pcs) | |
|------------------|---------------------|-------|
| | AMMO | Reel |
| J1/6ZCT26A | 2,000 | — |
| J1/6ZCT52□ | 2,000 | 5,000 |
| J1/4ZCT26A | 2,000 | — |
| J1/4ZCT52□ | 2,000 | 5,000 |

The code for package enters □.

Low Power Type Resistors

JL Jumper Wires

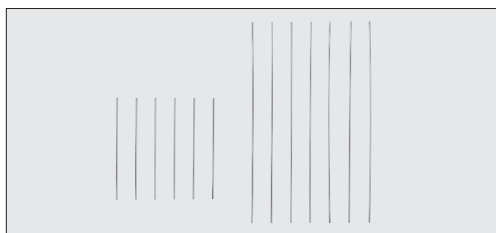

Coating : None

Features

- Automatic insertion is applicable.
- Products meet EU-RoHS requirements.

Ratings

| Type | Nominal Diameter | Max. Allowable Current |
|------|------------------|------------------------|
| JL5C | 0.5mm | 8A |
| JL6C | 0.6mm | 10A |

Dimensions (mm)

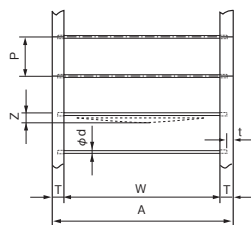

| Type | Dimension (mm) | | | |
|------|---------------------|-----------------|---------------|----------------|
| | W | P | T | Z |
| T26 | 26 ± 1.0 0 | 5.00 ± 0.3 | 6.2 ± 0.5 | 39 ± 1.0 |
| T52 | 52 ± 1 | 5.08 ± 0.38 | | 64.5 ± 1.0 |
| | d (Nominal) | t | T | Z |
| T26 | 0.5, 0.6 | 2.5 Max. | 6.2 ± 0.5 | 0.8 Max. |
| T52 | | | | |

Type Designation

Example

| JL | 6 | C | T26 | A |
|--------------|----------------------------|---------------------------|--------------------------------------|---------|
| Product Code | Nominal Diameter | Terminal Surface Material | Taping | Package |
| | 5: 0.5 (mm) 6: 0.6 (mm) | C : SnCu | T26: 26mm taping T52: 52mm taping | A: AMMO |

Contact us when you have control request for environmental hazardous material other than the substance specified by EU-RoHS.

For further information on taping, please refer to APPENDIX C on the back pages.